

# PACKAGE 11

3M x 5M Standard Booth

三米乘五米標準攤位

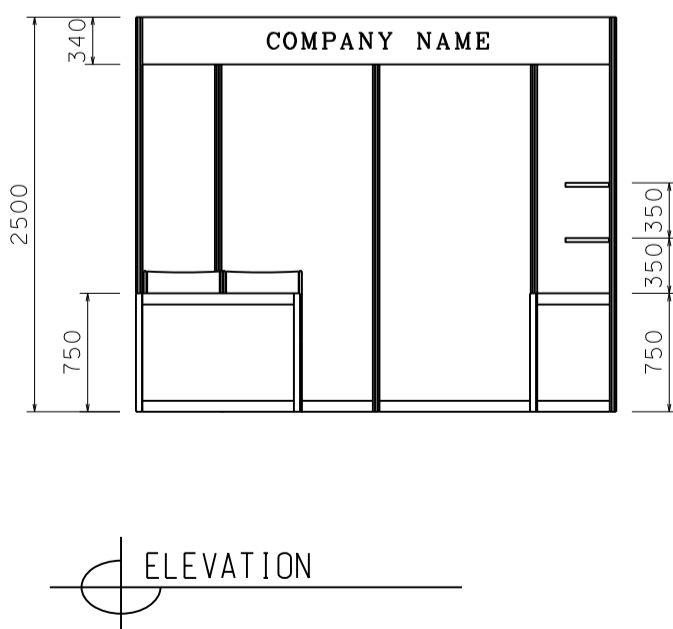
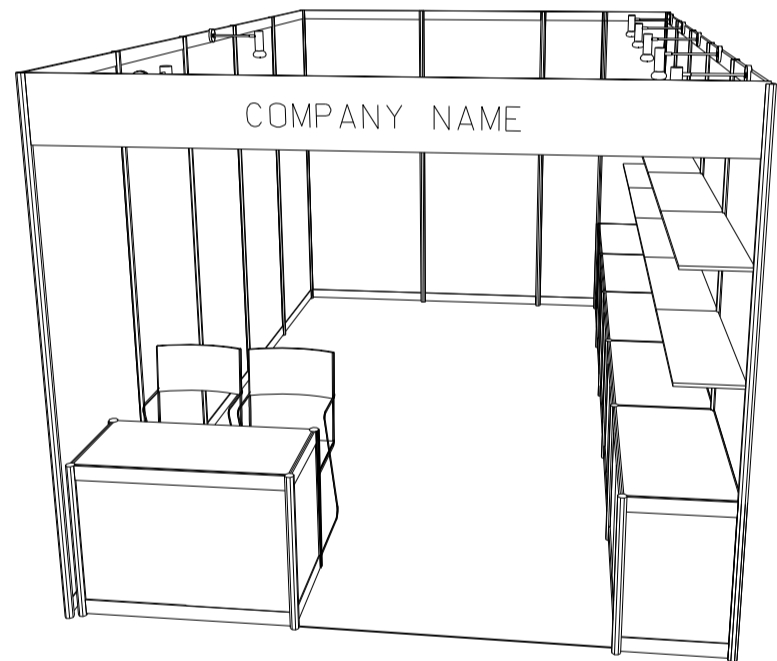
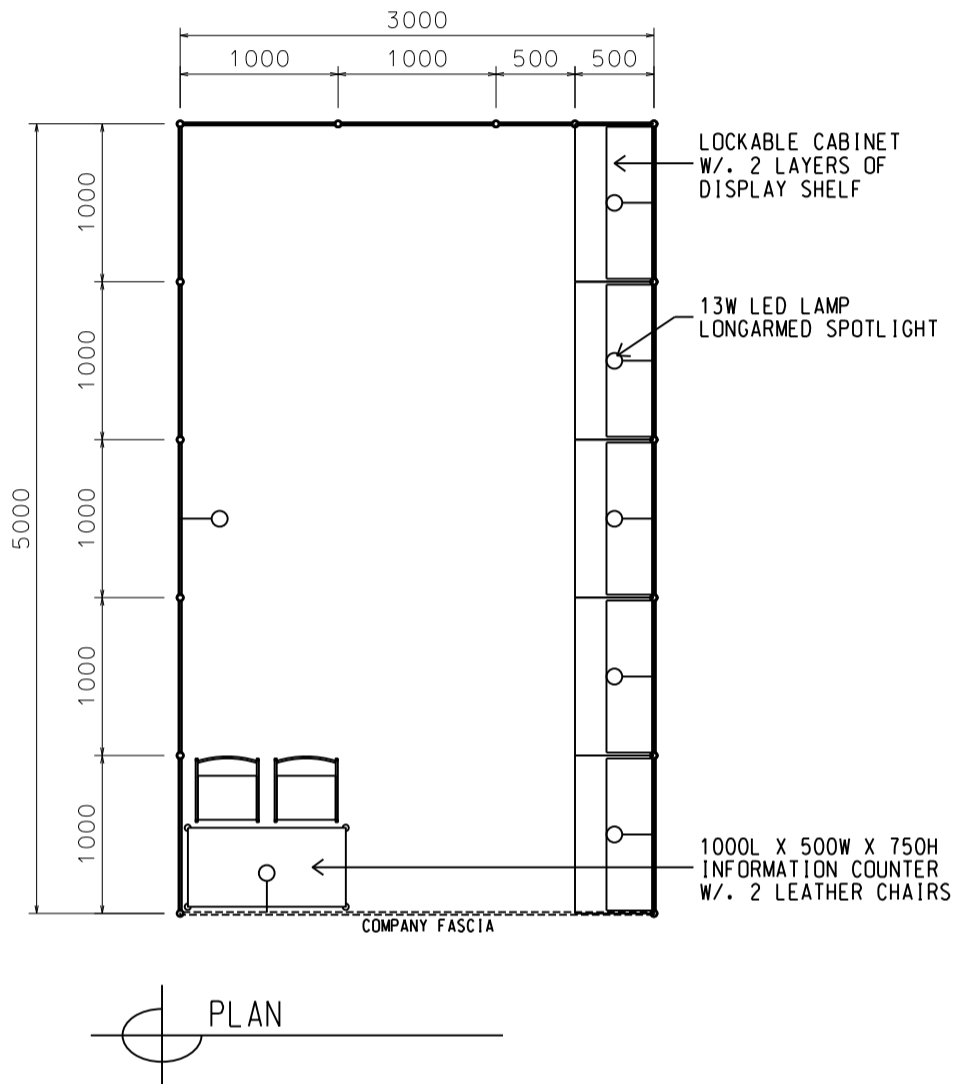

BOOTH SPECIFICATIONS		QTY.
	1000L x 500W x 750H INFORMATION COUNTER	1
	1000L x 500W x 750H LOCKABLE CABINET	5
	3000L x 300W DISPLAY SHELF	2
	2000L x 300W DISPLAY SHELF	2
	13W LED LAMP LONGARMED SPOTLIGHT (YELLOW LIGHT)	7
	BLACK LEATHER CHAIR	2
	RUBBISH BIN & CARPET (15sqm.)	

\*The Hong Kong Trade Development Council reserves the right to change the configuration if necessary.

\*如有需要，香港貿易發展局有權更改攤位結構。