

Premium Booth 3mW x 3mD One side open

WJ-A-9
3mW x 3mD x 3.5mH

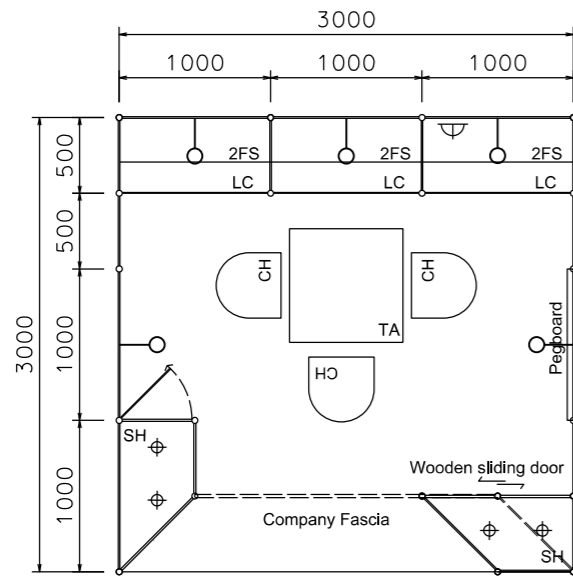

PLAN

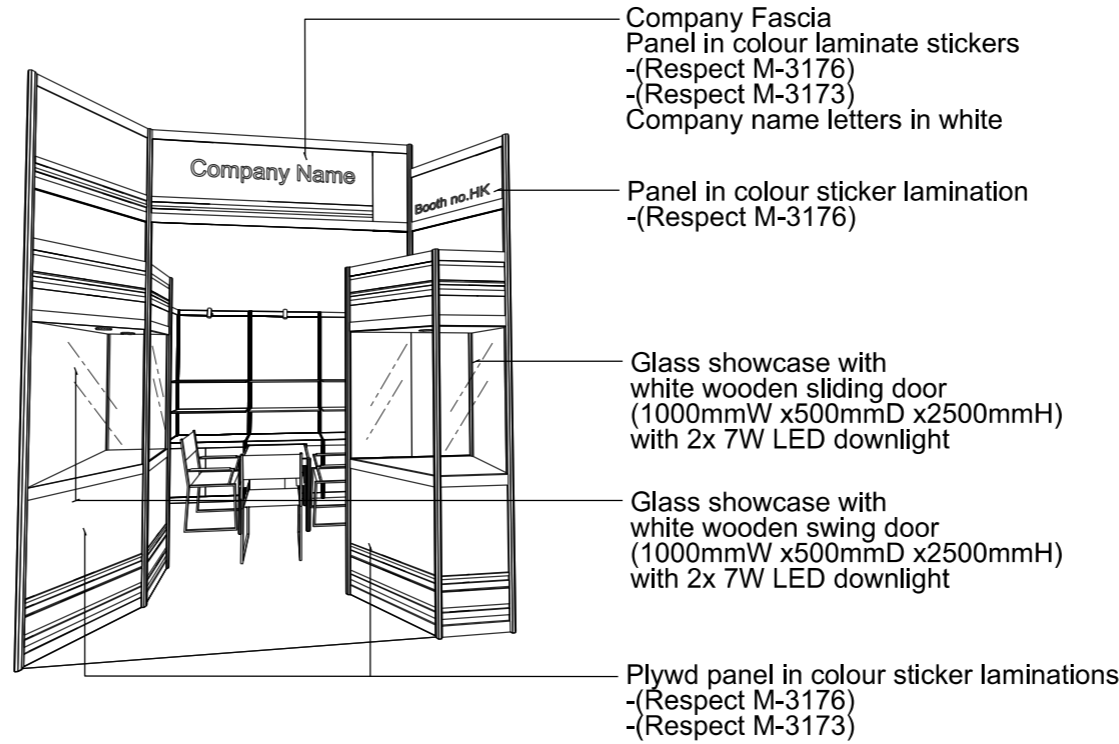

PERSPECTIVE N.T.S



COLOUR PERSPECTIVE N.T.S

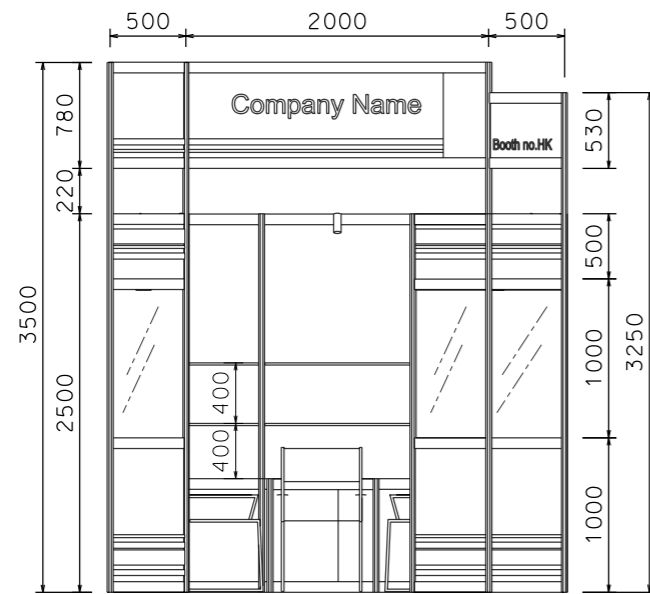

FRONT ELEVATION

BOOTH SPECIFICATION		QTY
	Front glass showcase in sticker lamination with white wooden swing door. 2 x 7W LED downlight (1M W x 0.5mD x 2.5M H)	1
	Front glass showcase in sticker lamination with white wooden sliding doors. 2 x 7W LED downlight (1M W x 0.5mD x 2.5M H)	1
	Lockable cabinet (1mL x 0.5mD x 0.75mH)	3
	Wooden shelf (flat) (1mL x 0.3mD)	6
	Pegboard with 30 hooks (1mW x 2.5mH)	1
	Square meeting table (0.7m X 0.7m x 0.75mH)	1
	Black leather chair	3
	Longarmed spotlight w/. 13W LED lamp (yellow)	5
	500w Square pin power socket	1

FILE PATH - \\10.10.8.25\Structure_Permanent_Data\Local_Fair_Premium_Booth_2011\WJ-A layout\WJ-A-2dLayout.dgn



NOTES UNLESS OTHERWISE SPECIFIED ALL DIMENSIONS ARE IN MM.

.....
.....
.....

.....
.....
.....

REVISION
15-06-2009
14-10-2009
22-10-2009
26-01-2010
15-05-2015
03-05-2019
31-12-2021

DATE: 03-05-2019
SCALE: 1 : 50 (A3)
DRAWN BY: ..
CHECKED BY:

TITLE
Premium Booth WJ-A-9

PROJECT
PREMIUM BOOTH 3m x 3m
DATE: XXXXXXXX

SHEET
WJ-A01