

# Premium Booth 3mW x 5mD One side open

WJ-A-15 - 3mW x 5mD x 3.5mH

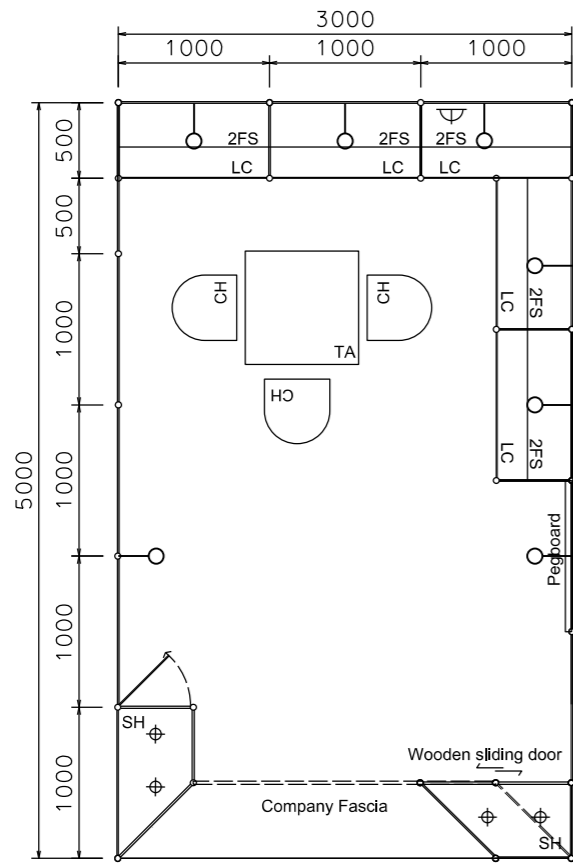

PLAN

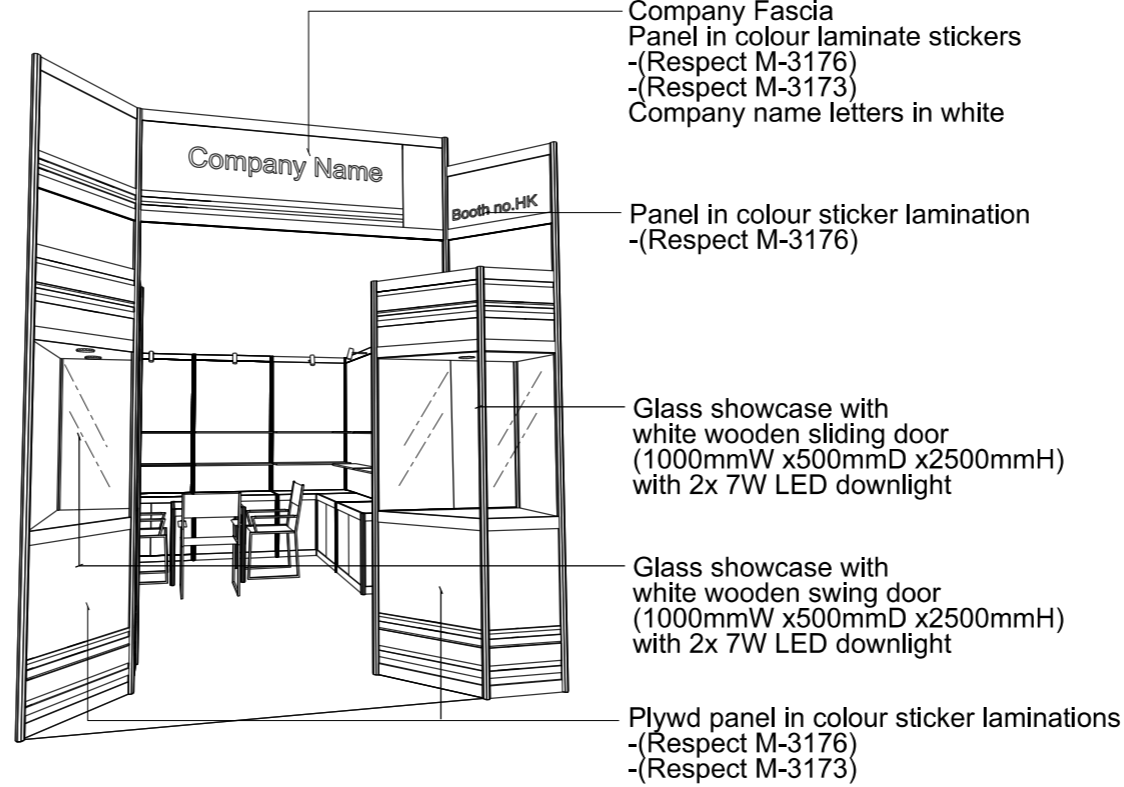

PERSPECTIVE N.T.S.



COLOUR PERSPECTIVE N.T.S.

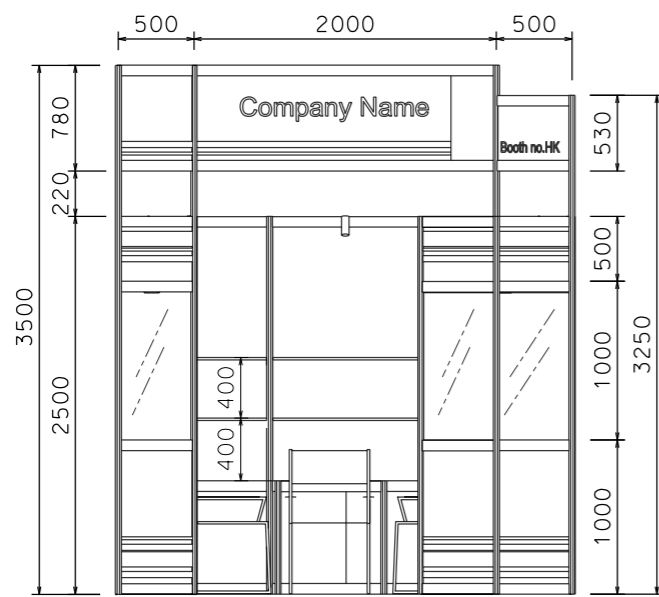

FRONT ELEVATION

BOOTH SPECIFICATION		QTY
	Front glass showcase in sticker lamination with white wooden swing door. 2 x 7W LED downlight (1mW x 0.5mD x 2.5mH)	1
	Front glass showcase in sticker lamination with white wooden sliding doors. 2 x 7W LED downlight (1mW x 0.5mD x 2.5mH)	1
	Lockable cabinet (1mL x 0.5mD x 0.75mH)	5
	Wooden shelf (flat) (1mL x 0.3mD)	10
	Pegboard with 30 hooks (1mW x 2.5mH)	1
	Square meeting table (0.7m X0.7m x 0.75mH)	1
	Black leather chair	3
	Longarmed spotlight w/. 13W LED lamp (yellow)	7
	500w Square pin power socket	1

FILE PATH - \\10.10.8.25\Structure\_Permanent\_Data\Local Fair Premium Booth 2011\WJ-A layout\WJ-A-2dLayout.dgn



NOTES UNLESS OTHERWISE SPECIFIED ALL DIMENSIONS ARE IN MM.

.....  
.....  
.....

REVISION  
15-06-2009  
23-10-2009  
20-01-2010  
15-05-2015  
03-05-2019  
31-12-2021

DATE: 03-05-2019  
SCALE: 1 : 50 (A3)  
DRAWN BY: ..  
CHECKED BY: .....

TITLE  
Premium Booth  
WJ-A-15

PROJECT  
PREMIUM BOOTH  
3m x 5m  
DATE: XXXXXXXX

SHEET  
WJ-A03